

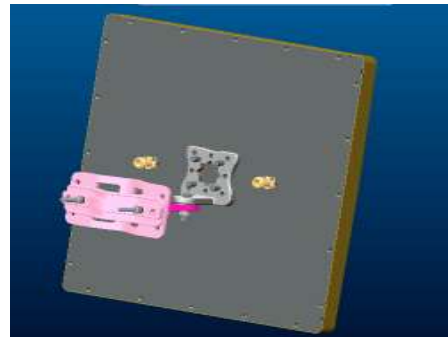

Panel Antenna *3.3-3.8/19.5dBi Dual Slant*



Model: [RFPA-3338-19.5D16](#)

RFPA-3338-19.5D16 is a professional broadband Dual Polarity/Dual Slant panel antenna that combines high gain with a 16° beamwidth and is designed for service provider applications in the 3.3-3.8GHz frequency band.

Main Electrical Specifications

Frequency	3.3-3.4Ghz	3.4-3.6Ghz	3.6-3.8Ghz
Gain (V Port)	18dBi	18.5dBi	19.5dBi
Gain (H Port)	18dBi	18.3dBi	19.0dBi
VSWR	≤1.7 (V Port), ≤1.5 (H Port)		
Upper Side Lobes	>18dB (V Port), >18dB (H Port)		
Front-to-back Ratio	>30dB		
Polarization Type	Vertical & Horizontal		
3dB H-Plane Beamwidth	16°		
3dB V-Plane Beamwidth	16°		
Maximum Input Power	100 Watt		
Impedance	50Ω		
Lightning Protection	DC Grounded		

Main Mechanical Specifications

Connector Type	2 x N Female
Dimensions	15.7×15.7×.86 inches
Weight	6 lbs.
Mounting Mast Diameter	1.25”~1.88”
Operating Temperature	-40° F to 149° F
Rated Wind Velocity	135 mph
Radome Material	UV Protected ABS

